

### Frame Construction

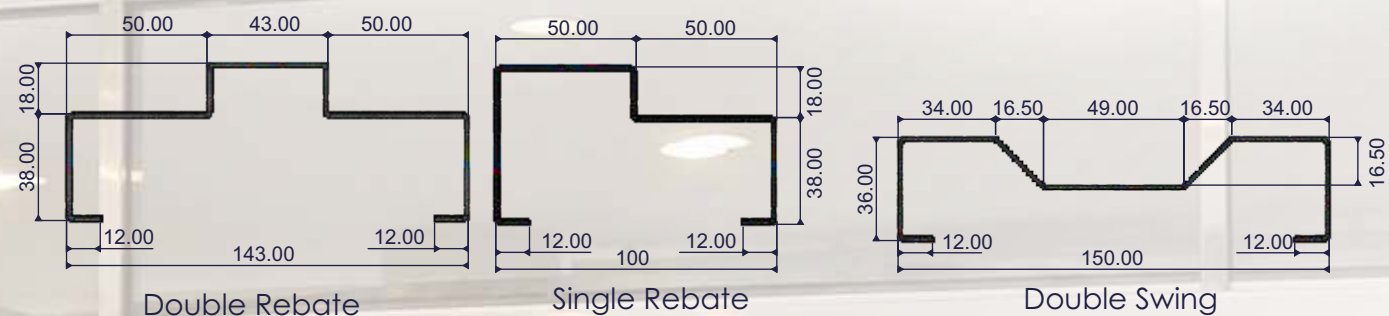

❖ All dimensions are in mm

### Hinge & Frame Assembly Details

Hinge Provision

Mitered Joint

Butt Joint

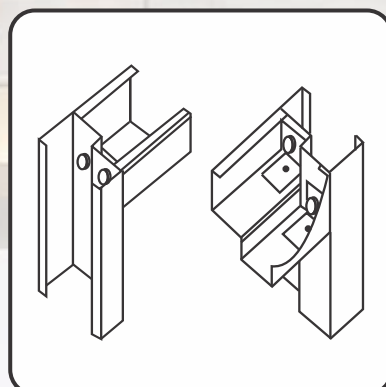
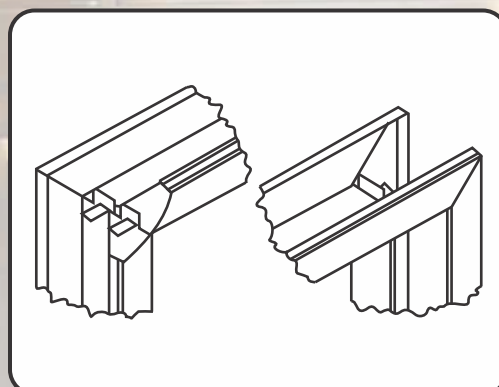
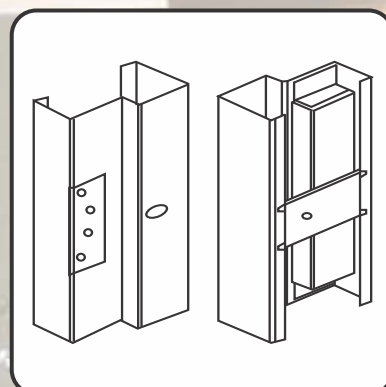

### Handing of Doors

Single Door

Double Door

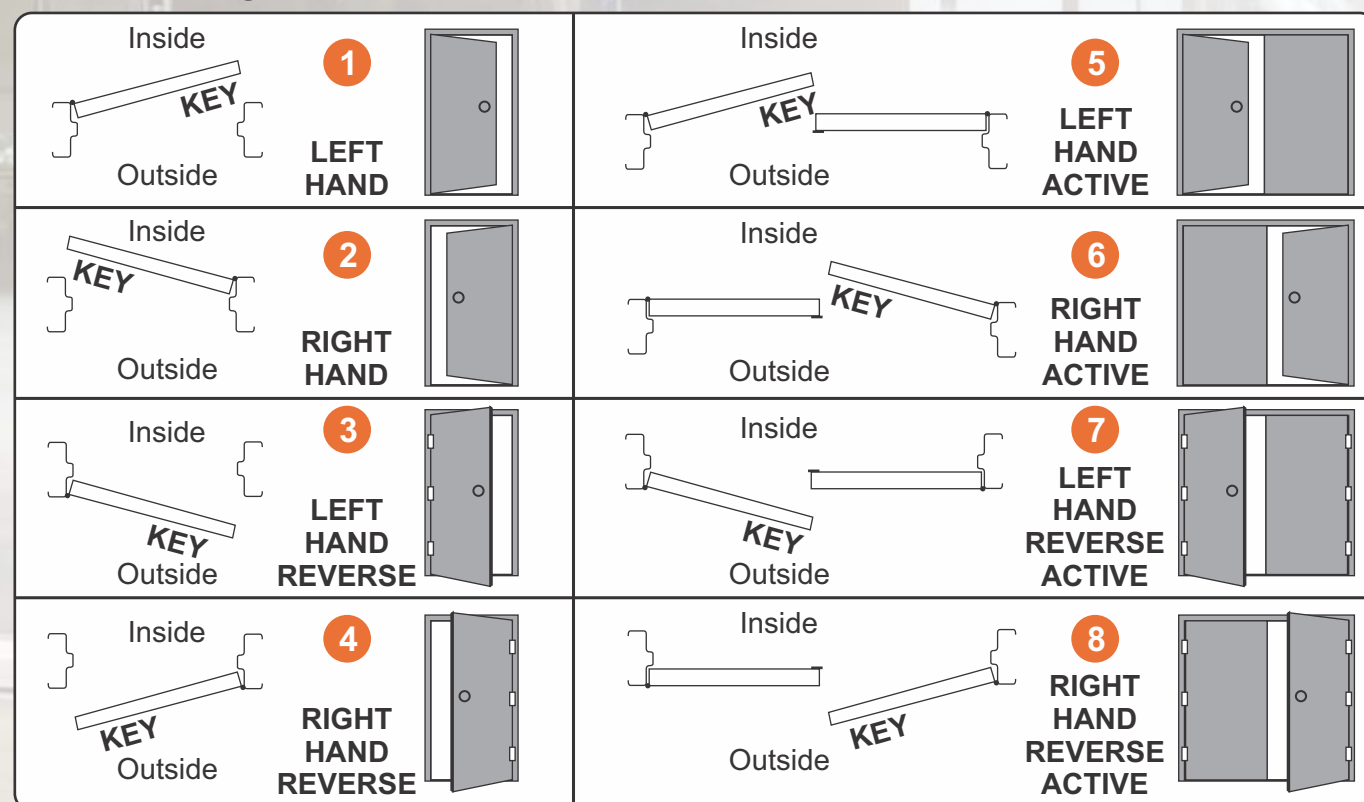

Note:

To identify the handing of doors refer from key side (Always Key is outside)

### Door Nomenclature

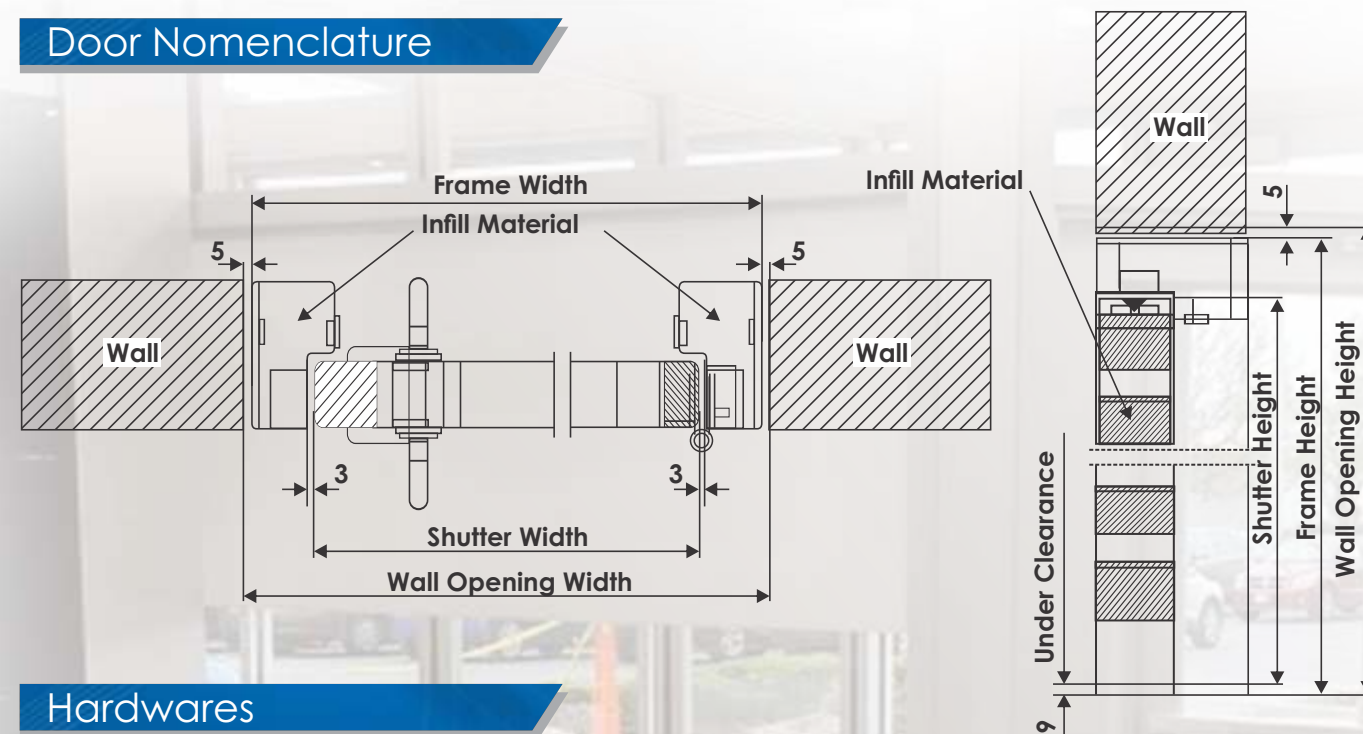

### Hardwares



### Color Shade

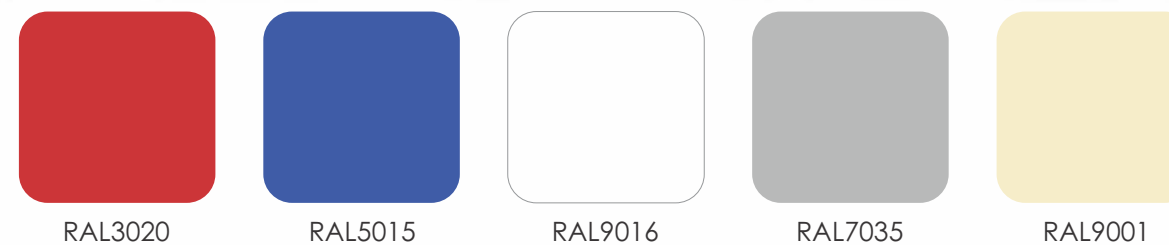

### INSTALLATION

All frames and doors should be installed on respective opening with fasteners and accessories as per our Product standard procedure with our company representative supervision.

Quality assurance at all levels of process, veeromfg facilities certified to ISO:9001:2015, OHSAS 18001:2007; IATF-16949-2016: EN15085

AN ISO 9001-2015 CERTIFIED COMPANY

Manufactured by  
**VEER-O-METALS Pvt. Ltd.**

#87/A, 1<sup>st</sup> Phase, Jigani Industrial Area, JiganiHobli,  
Anekal Taluk, Bangalore - 560105 INDIA,  
Tel: +91-81-10420000, Mob. +91 812341122, Fax: +91-8110420099,  
Email: info.marketing@veerometals.com, nagaraju.mareedu@veerometals.com  
www.veerometals.com

Design and specifications are subjected to change without prior notice, no liability accepted.

VEERO METAL DOORS



SAVE WOOD

Prevent Global Warming



BRING CHANGE



Doors for Residential, Commercial and Industrial uses.



### About company

Veero-O-Metals Pvt Ltd established in the year 1965, an ISO 9001 Certified company, we are engaged in manufacturing of precision sheet metal fabrication parts, machined components and mechanical assemblies. We have an in-house strong mechanical engineering and manufacturing team for design and development, dedicated in providing high end design solutions which are industry specific. Veero has established a strong client base nationally and internationally with our transparent and Global practices. The group has its Mfg locations in India & Philippines.

### Our Technology

At Veero we have the latest technologies, machineries as well as processes & quality Management system. Having 50 + years of experience in Mfg, we believe adoption of appropriate technology is the only means of converting MANKIND dreams into reality, with this principle Veero is proud to introduce VEERO BRANDED eco-friendly product sheet metal doors for Home, office and Industrial uses. Veero metal doors add value in preventing global warming. The Doors & frames are designed by using hi-end design software as per the specification of the customer.

### Product Quality

Our process speaks for the quality that we give. Veero doors are made with galvanized steel sheets of 0.8mm, 1.2mm & 1.6mm as per ASTM A525 / JIS 3302, zinc coating 120 grms/sqmt, with infill material like paper honeycomb, puf & rock wool (as per customer specific). The metal doors are powder coated with pure polyester powder to withstand weather condition with good aesthetics & superior quality. We are using best quality sheets and hardware which are the basic requirement for manufacturing quality product and further augmented with CNC oriented flexible manufacturing facility. Product is invariably subjected to procedures of QMS at various stages of manufacturing process.

### Comparison - sheet metal door & wooden door

Character	Sheet metal door	Wooden door
Saves ecology	Yes	No
Cost effective	Yes	No
Strength	Stronger	Limited
Life span	More durable	Limited
Aesthetic	Your imagination at our catalogue	Cost dependant
Dimensional consistency	Cent percent	Conditional
Insulation	Ideal	Average
Water proof	Yes	No
Termite proof	Yes	No
Fire retardant	Yes	No
Noise Proof	Yes	No
Installation time	Rapid	Time consuming

### Classification of Doors

- Residential Doors
- Commercial Doors
- Industrial Doors

### Range of Doors

- Flush Doors
- Panel Doors – View / Louvers provision
- Emergency Doors
- Clean Room Panel & Doors
- Cold Room Panel & Doors
- Fire rated Doors
- FHC Doors
- Shaft Doors
- Sliding Doors
- Swing Doors

### THE STANDARD STEEL DOOR CONSTRUCTION SPECIFICATION

Specification	Flush Door	Panel Door with Glass and louvers	Emergency Door	FHC Door	Shaft Door	Sliding Door	Swing Door	Fire rated Door
Material	Galvanized steel sheets- ASTM 525/ JIS G 3302	Galvanized steel sheets- ASTM 525/ JIS G 3302	Galvanized steel sheets- ASTM 525/ JIS G 3302	Galvanized steel sheets- ASTM 525/ JIS G 3302	Galvanized steel sheets- ASTM 525/ JIS G 3302	Galvanized steel sheets- ASTM 525/ JIS G 3302	Galvanized steel sheets- ASTM 525/ JIS G 3302	Galvanized steel sheets- ASTM 525/ JIS G 3302
Sheet Thickness in mm	Shutter-0.8 Frame 1.2	Shutter-0.8 Frame 1.2	Shutter-0.8 Frame 1.2	Shutter-0.8 Frame 1.2	Shutter-0.8 Frame 1.2	Shutter-0.8 Frame 1.2	Shutter-0.8 Frame 1.2	Shutter-1.2 Frame1.6
Shutter Thickness in mm	46	46	46	25	50	46	46	48 & 50
Infill Material	Honey Comb/EPS	Honey Comb	Honey Comb	No	Honey Comb	Honey Comb	Honey Comb	Rock-wool/ Mineral Wool
Frame Assembly	Mitered joint- Butt joint	Mitered joint- Butt joint	Mitered joint- Butt joint	Mitered joint- Butt joint	Mitered joint- Butt joint	Mitered joint- Butt joint	Mitered joint- Butt joint	Mitered joint- Butt joint
Glazing	No	Glazing to door leaf	Glazing to door leaf	Glazing to door leaf	No	Glazing to door leaf	Glazing to door leaf	Glazing to door leaf
Louvers	NO	Yes	NO	NO	NO	NO	NO	NO
Fire resistance	NO	NO	NO	NO	NO	NO	NO	30,60,90, 120Min
Surface finish	Powder Coating	Powder Coating	Powder Coating	Powder Coating	Powder Coating	Powder Coating	Powder Coating	Powder Coating
Applications	Residential	Commercial	Commercial Industrial	Commercial Industrial	Commercial Industrial	Commercial Industrial	Commercial Industrial	Commercial Industrial

### Technical Data

- Technical specification covers the design, Manufacture in house & supply of material along with installation.
- **Material** : Frame-standard frame manufactured from 1.2 mm (18 gauge) Galvanized steel sheets IS 277 code GPL grade with Z120 coating.
- **Door shutter** : Manufactured from 0.8mm (22 gauge) galvanized steel sheets.
- **Infill material** : Doors shall be reinforced with craft paper honeycomb and pressed to both inside of shutter panel sheets, along with suitable reinforcement provided.
- **Finish** : All doors & frames shall be powder coated with pure polyester grade powder of approved colour & have passed for min 250 hours salt spray test.
- **General Mfg** : Door frames profile be single rebate or double rebate and provisions designed to suit for fixing the door accessories as per the standard requirement.
- **Installation** : All frames & doors should be installed as per the specification provided in the installation manual provided by the Manufacturer.

### Range of Doors

